

#2032

2-Bedroom Apartments, Ypsonas, Limassol

📍 Ypsonas, Limassol

€275,000 +VAT



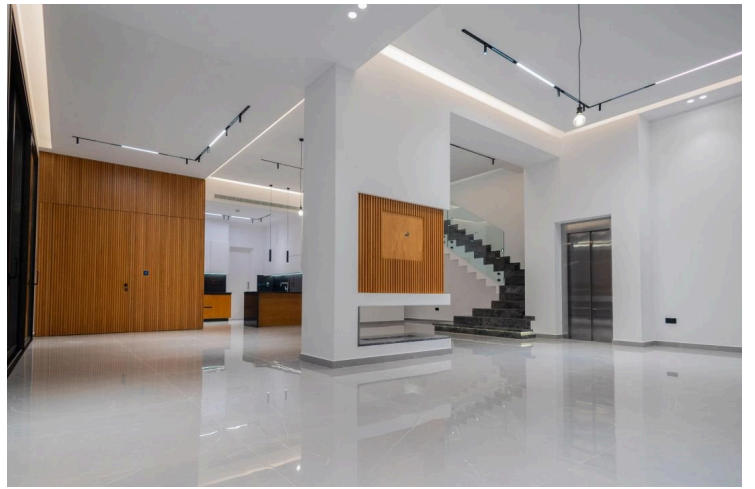

Overview

Specifications

Bedrooms

 2

Bathrooms

 2

Covered

 79 m²

Type **Apartment**

Covered veranda **26 m²**

Covered parking **11 m²**

Status **Under construction**

Year of construction **2026**

Energy efficiency rating  **A**

Description

Presenting this impressive three-floor building located in the upcoming area of Ypsonas in Limassol.

Conveniently situated just a short 2-minute drive from the highway, this property offers easy access to a plethora of amenities. Designed and constructed with careful attention to detail, it appeals to both discerning renters and potential buyers.

Boasting outstanding features and top-notch amenities, these apartments ensures a life of sophistication and comfort. Its proximity to schools, shops, banks, and other essential services makes it an ideal choice for those seeking an upscale urban living experience.

Apartments Availability:

- Covered Areas: 79m2

- Covered Verandas: 17m2-26m2

Price From: €275.000 + VAT

Contact us today for detailed information



Additional information

Facilities

Aircondition, Split system

Parking, Covered

Storage

Features

Balcony

Bright

City view

Door screen

Double glazing

Easy access to highway

Easy access to main roads

Elevated

Guest WC

Investment opportunity

Near amenities

Open plan

Rental potential

